

MILILAB · TOKYO

# ENWA

Architect-Standard Furniture

Published prices · DDP to 34 countries · FAS-grade North American oak

円 (EN) · 和 (WA)

# Looks Sharp. Feels Soft.

We began with a reaction, not a style. What happens when the edge the eye reads as precise is the same edge the hand wants to follow? ENWA is eight solid oak pieces shaped around that question. 円 is the circle. 和 is harmony. Not as symbols — as a way of removing anything that interrupts the body.

A reverie, held in oak.

Founded by former Kengo Kuma & Associates architects





THE EDGE

Where the eye expects sharpness,  
the hand finds softness.

---

From across the room, the edge reads as precise.  
Under your fingertips, it stops behaving like an edge  
at all. The eye and the hand arrive at two different  
pieces — which is when you know the subtraction worked.

SORA · KAWA

# There is no bad side.

The back of a sofa is what most people see, most of the time. We designed it first. Moveable backrests let a guest read alone, then turn to face a conversation, without moving the frame. Scalable past six metres. The frame holds; the room adapts around it.



SEN · MARU

Maru: no head  
of table.

Sen: no corner  
to flinch from.

---

A rectangular table assigns authority — someone sits at the end. Maru dissolves that hierarchy entirely. Sen takes the opposite direction: long, but with every corner softened so the room breathes.

Maru seats 4–6 · Sen 2200 seats 6–8 · Sen 3200 seats 8–10



YUME

## Designed back first.

In an open-plan room, the rear of a chair is what people see when they're not sitting in it. We treated it as the true face of the piece — not because we planned to create a sensation, but because that's what the architecture was asking for.

Solid oak frame · Kvadrat or Dedar upholstery

Stackable · FSC-certified

Yume from \$2,400



ISHI · 石

## One volume that refuses to declare what it is.

---

A stone in a garden is a seat, a table, a sculpture,  
or nothing at all. The meaning lives in the encounter,  
not the object. Ishi began with a question: what is  
the minimum number of decisions required to make a seat?

420 × 420 × 440mm · Kvadrat / Dedar / leather / COM

KAWA · TSUKI · SHIZU

## For the rooms in between.

Not every piece wants to be the centre of the room. Kawa — bench or loveseat, depending on the moment — anchors a corridor, the foot of a bed, the pause before a spa. Tsuki and Shizu hold the quiet ground beside it.

Kawa 1800 × 450mm · Tsuki Ø800mm · Shizu 1200 × 600mm



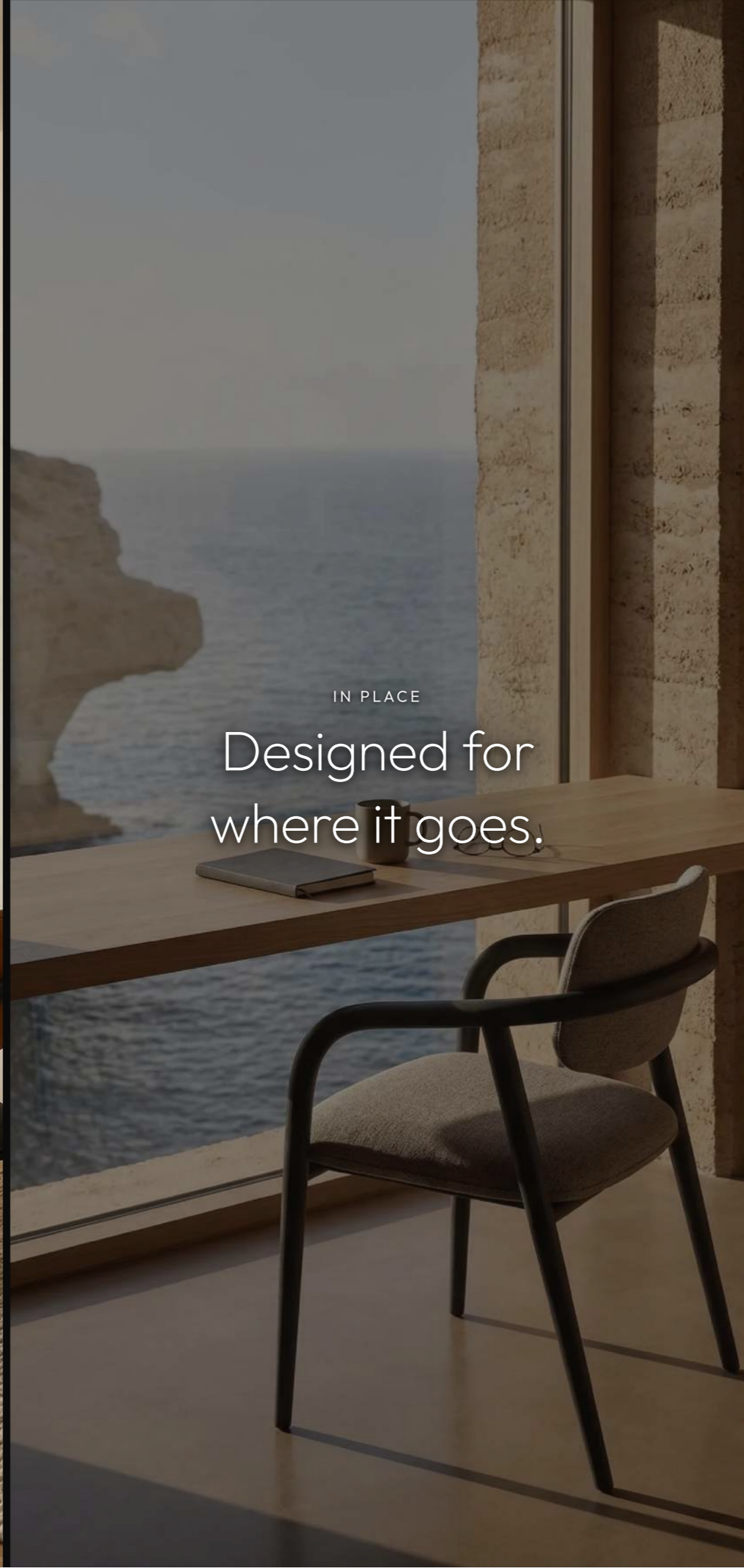

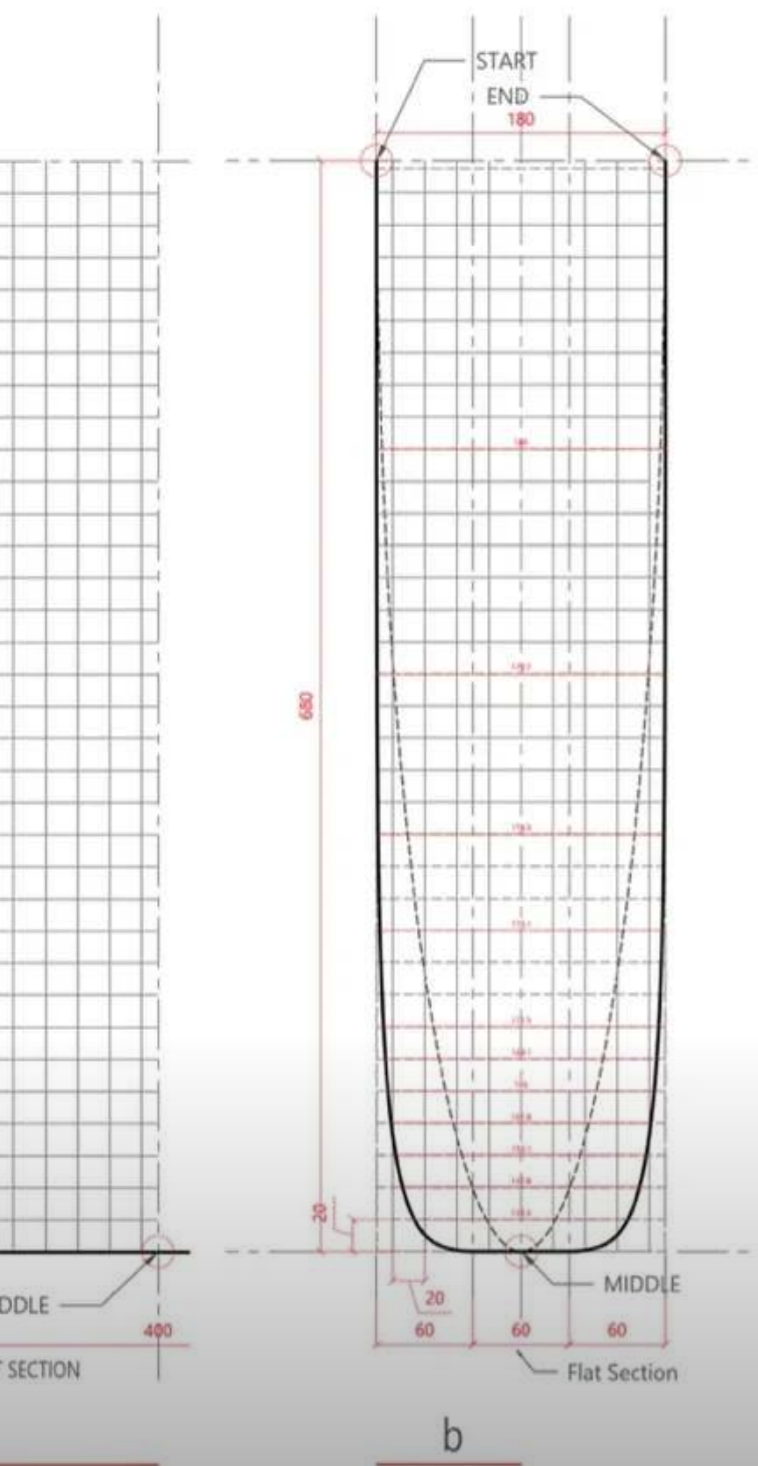

3 ENWA - SEN DINING TABLE 3200 - PLAN  
TABLE FOOT 1:5

4 ENWA - SEN DINING TABLE 3200 - SECTION C-C  
TABLE EDGE 1:3

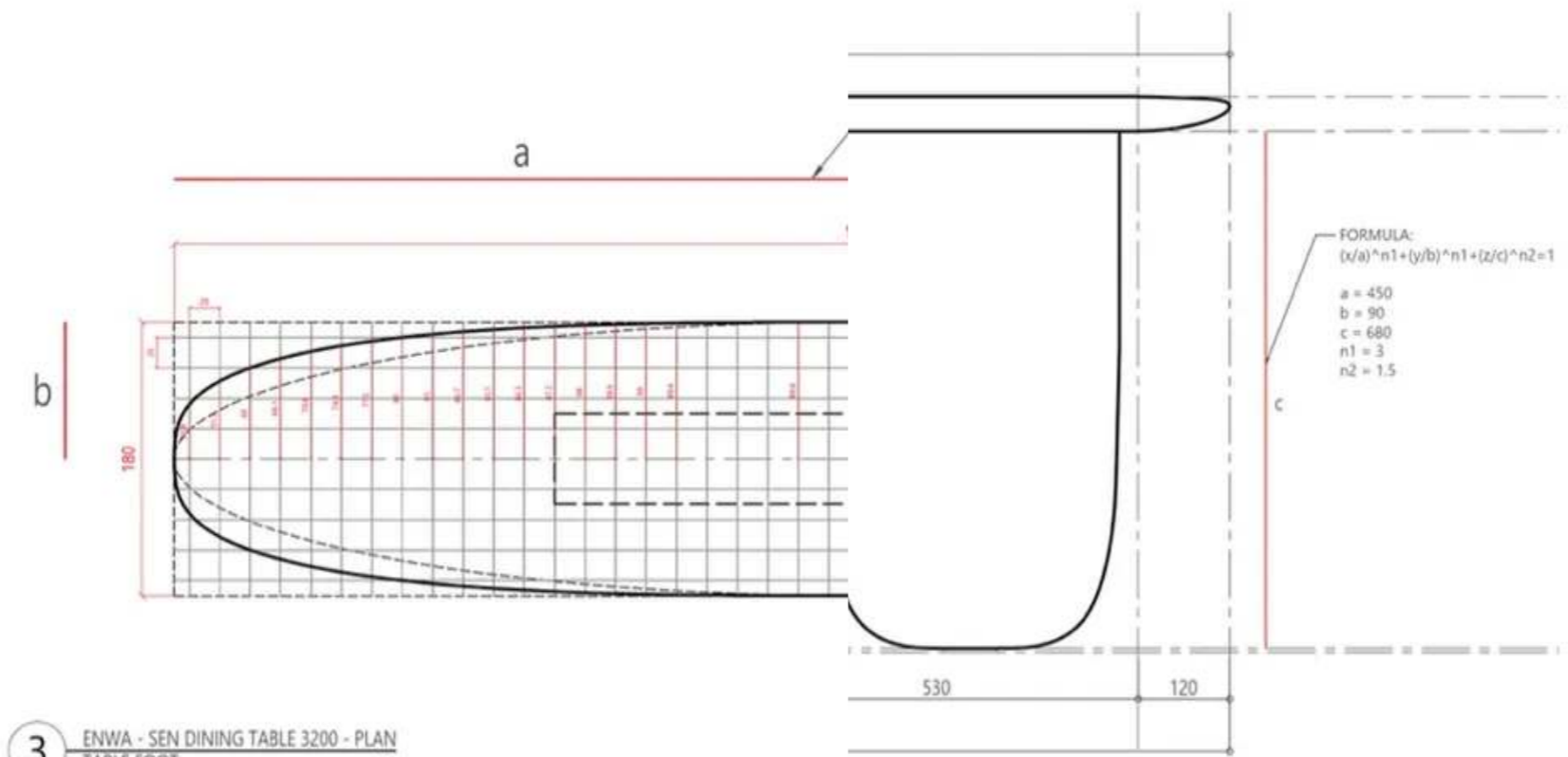

E:  
a standard fillet  
a constant radius  
a circular arc.

metric Profile  
red by script\_enwa v2

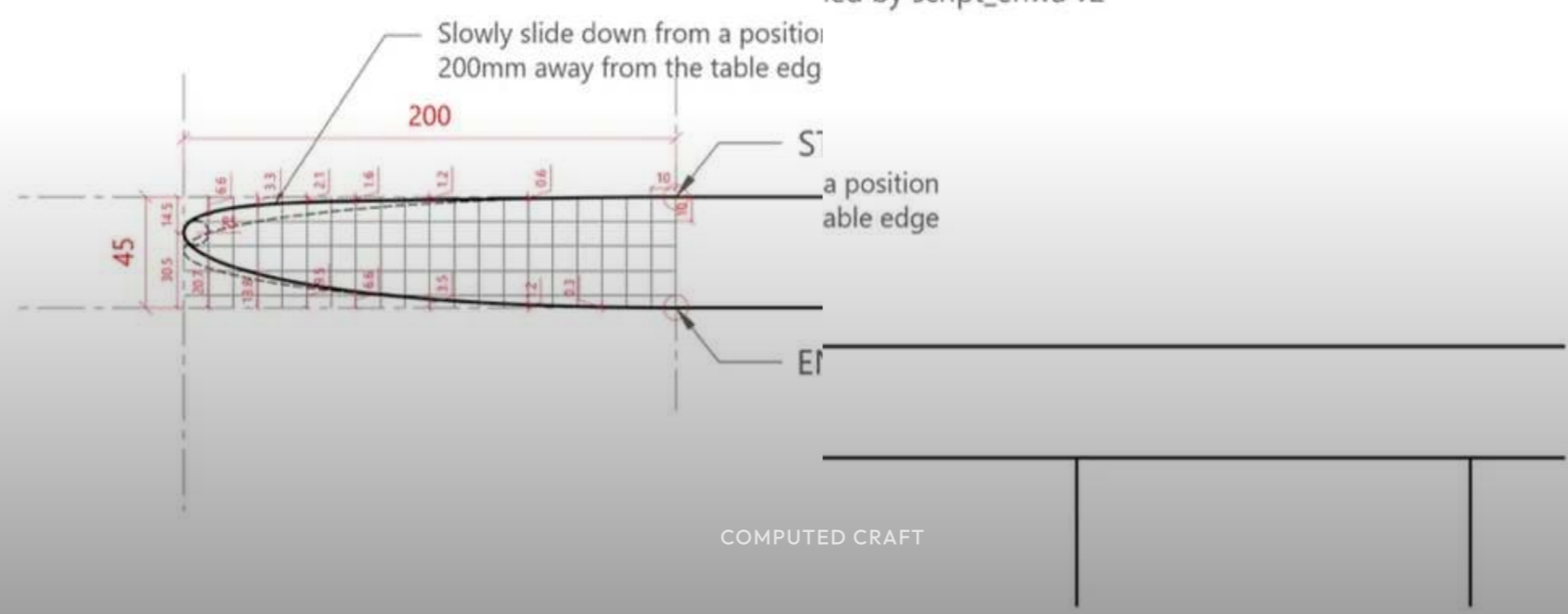

COMPUTED CRAFT

Not drawn.  
Calculated.

Every curve, every taper, every joint angle solved in code.  
Then sanded by hand until you can't feel the calculation.

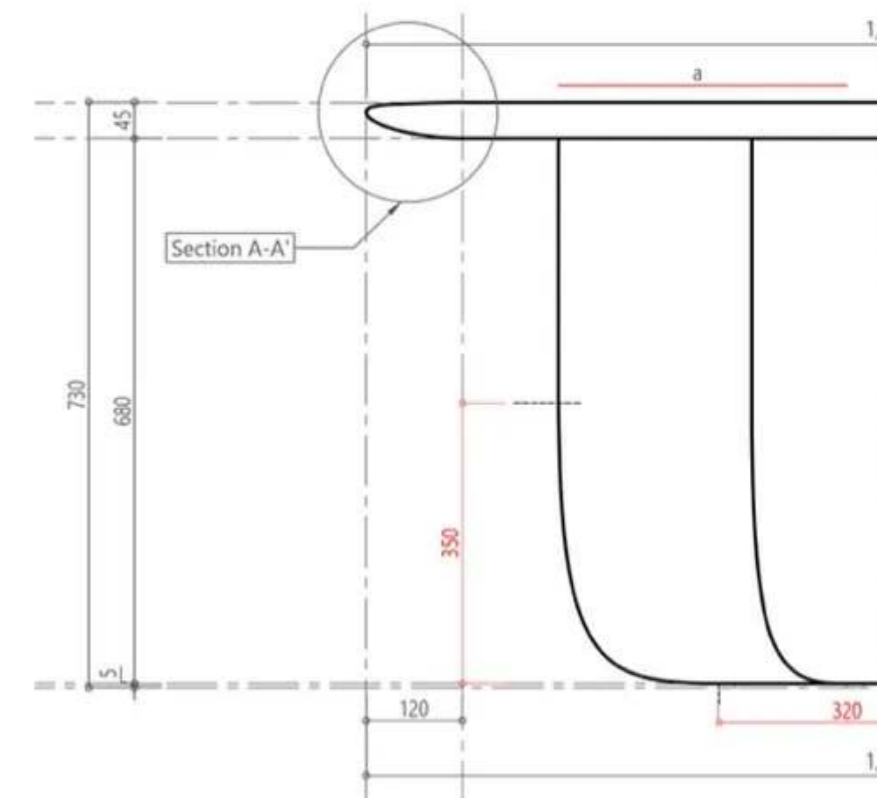

2 ENWA - MARU DINING TABLE 1300 - FRONT ELEVATION  
TABLE 1:10

3 ENWA - MARU DINING TABLE 1300 - PLAN  
TABLE 1:10

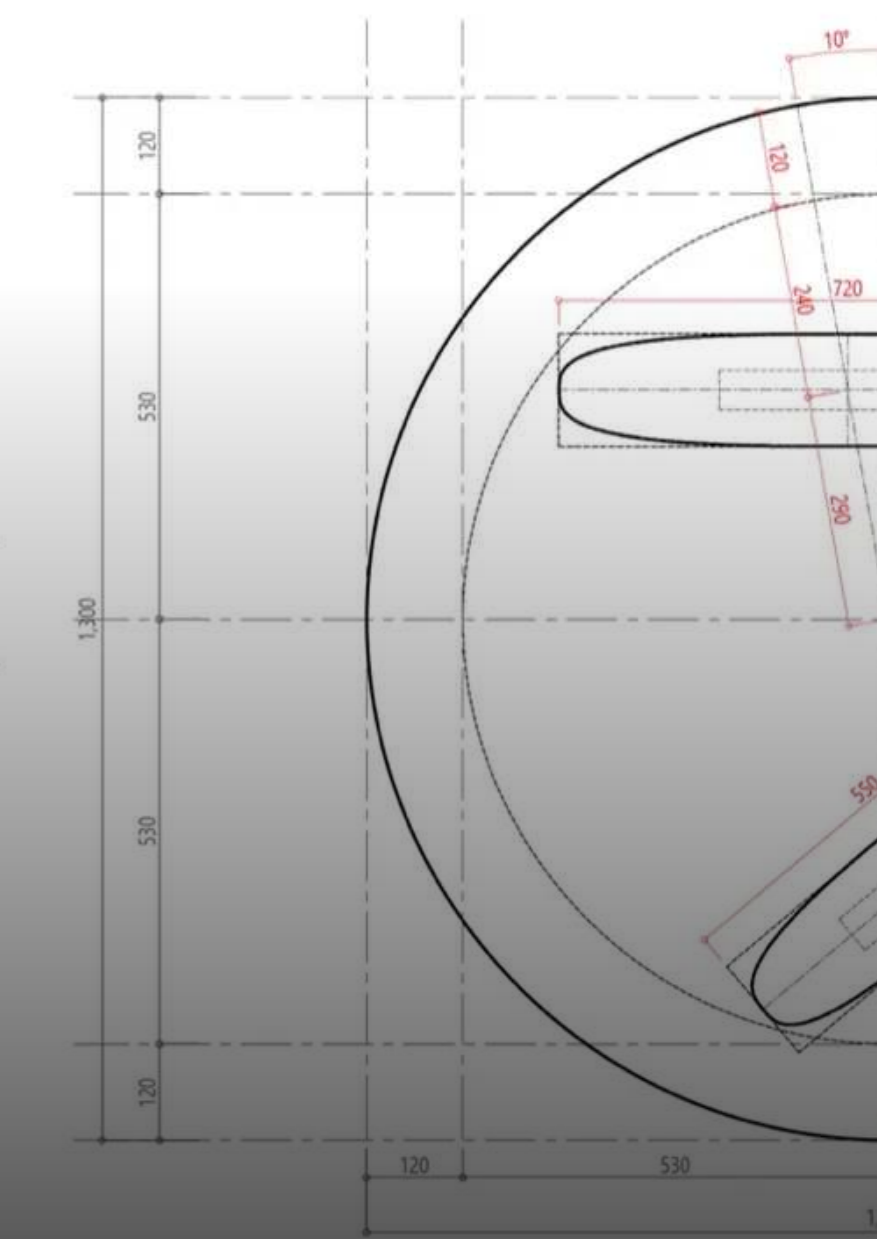

A close-up, high-resolution photograph of a wood grain, showing the intricate patterns and textures of the wood fibers. The lighting is soft, highlighting the natural variations in color and grain structure.

MATERIAL

Solid oak.  
Twice kiln-dried.  
FAS grade.

---

FAS is the highest grade for clear, consistent surface in North American hardwood. Dried twice, because one pass gets the moisture out but rarely gets it even. What remains is wood that moves predictably across seasons — which is what a piece this continuous requires.



UPHOLSTERY

Kvadrat standard.  
Dedar premium.  
Your COM welcomed.

---

Kvadrat wool as standard. Dedar Karakorum and Mélange Moderne as premium. Every option FR-rated for international hotel compliance. Frames engineered to receive a client's own material cleanly.

Martindale 50,000+ · Crib 5 available · 120+ colourways

**KVADRAT** DEDAR ALCANTARA

Kvadrat Savanna · GREENGUARD certified

Dedar Karakorum · 80,000 Martindale

Alcantara · 30,000 cycles

Scan with iPhone · Open in Safari · View at true scale



**Ishi Stool**  
 420 × 420 × 440mm  
 \$1,800





**Yume Chair**  
 580 × 560 × 740mm  
 \$2,400





**Tsuki Coffee Table**  
 Ø800 × 350mm  
 \$4,000





**Shizu Low Table**  
 1200 × 600 × 350mm  
 \$4,800





**Kawa Bench**  
 1800 × 450 × 440mm  
 \$5,800





**Maru Round Dining**  
 Ø1200 × 720mm  
 \$8,500

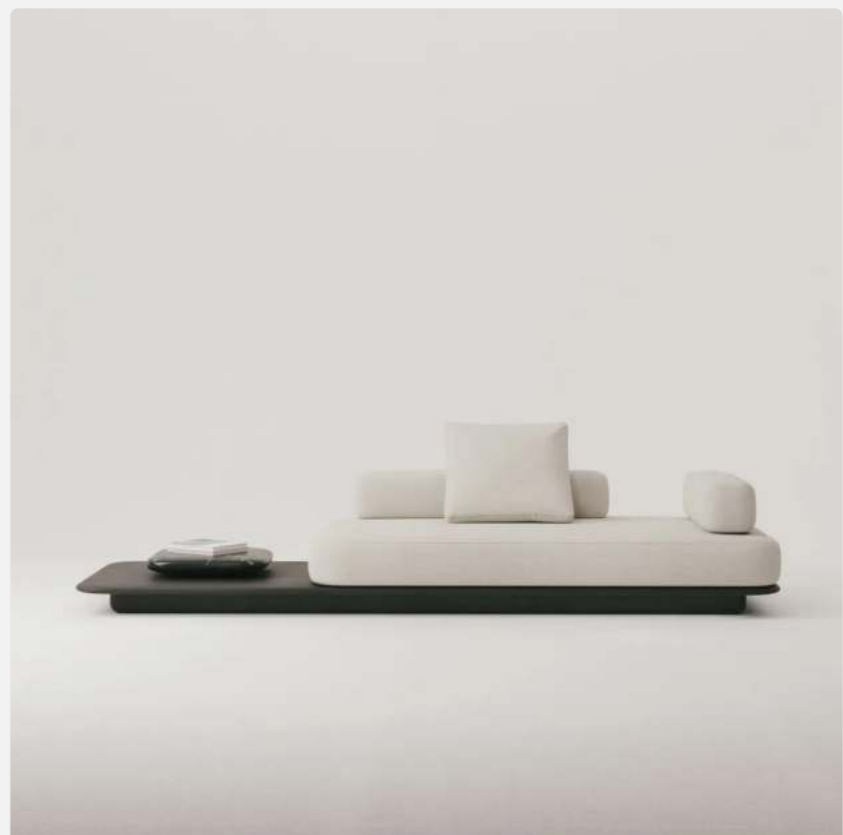

**Sen Dining Table**  
 2200 / 3200 × 950mm  
 from \$9,800

**Sora Sofa System**  
 Modular · 4 configurations  
 from \$13,400





ARCHITECT-STANDARD SPECIFICATIONS

## Every ENWA piece ships with verifiable data.

- FAS-grade North American white oak — kiln-dried to 6–8% moisture
- 50,000+ cycle joinery testing — mortise-and-tenon, 10-year structural warranty
- International fire-retardancy — BS 5852 · NFPA 260 · Cali TB 117
- Premium textile certifications — Kvadrat GREENGUARD · Dedar 80,000 Martindale
- DDP to 34 countries — 6–8 week lead time · Mililab = Importer of Record
- Published trade pricing — Tier 1: 25% off · Tier 2: 40% off · Tier 3: 45–55%



DESIGNED IN TOKYO

# Manufactured by the world's best.

---

Design IP and quality control in Tokyo.  
Production by master cabinet makers worldwide.  
The same model the world's most valuable  
design companies have proven: the postcode  
doesn't determine the standard.

Tokyo Design Lab · Global Manufacturing

HOSPITALITY PROGRAMME

# Built to deliver at hotel scale.

## MATERIAL

100% FAS-Grade North American oak — the highest hardwood yield. Defect-free grain continuity.

## FIRE & COMPLIANCE

BS 5852 Crib 5 · CAL 117-2013  
Low-VOC finishes. All upholstery FR-rated to hotel standards.

## LEAD TIME & LOGISTICS

6–8 week lead time.  
DDP to 34 countries.  
Mililab = Importer of Record.

## SITE-SPECIFIC DEVELOPMENT

We re-engineer scale, pitch, and ergonomics for your property. Prototype to production.

## PRODUCTION & QC

Dedicated manufacturing partner. Full QA staging before shipment. 500+ piece capacity per project.

## WARRANTY & AFTERCARE

10-year structural warranty. Replaceable upholstery covers. On-site touch-ups supported.

Tier 1 — Design Trade

Tier 2 — Contract/Hospitality

Tier 3 — Project Partner

25% off · Licensed A&D · 1+ pieces  
40% off · 10+ pieces per SKU  
45–55% off · 50+ pieces or \$100K+

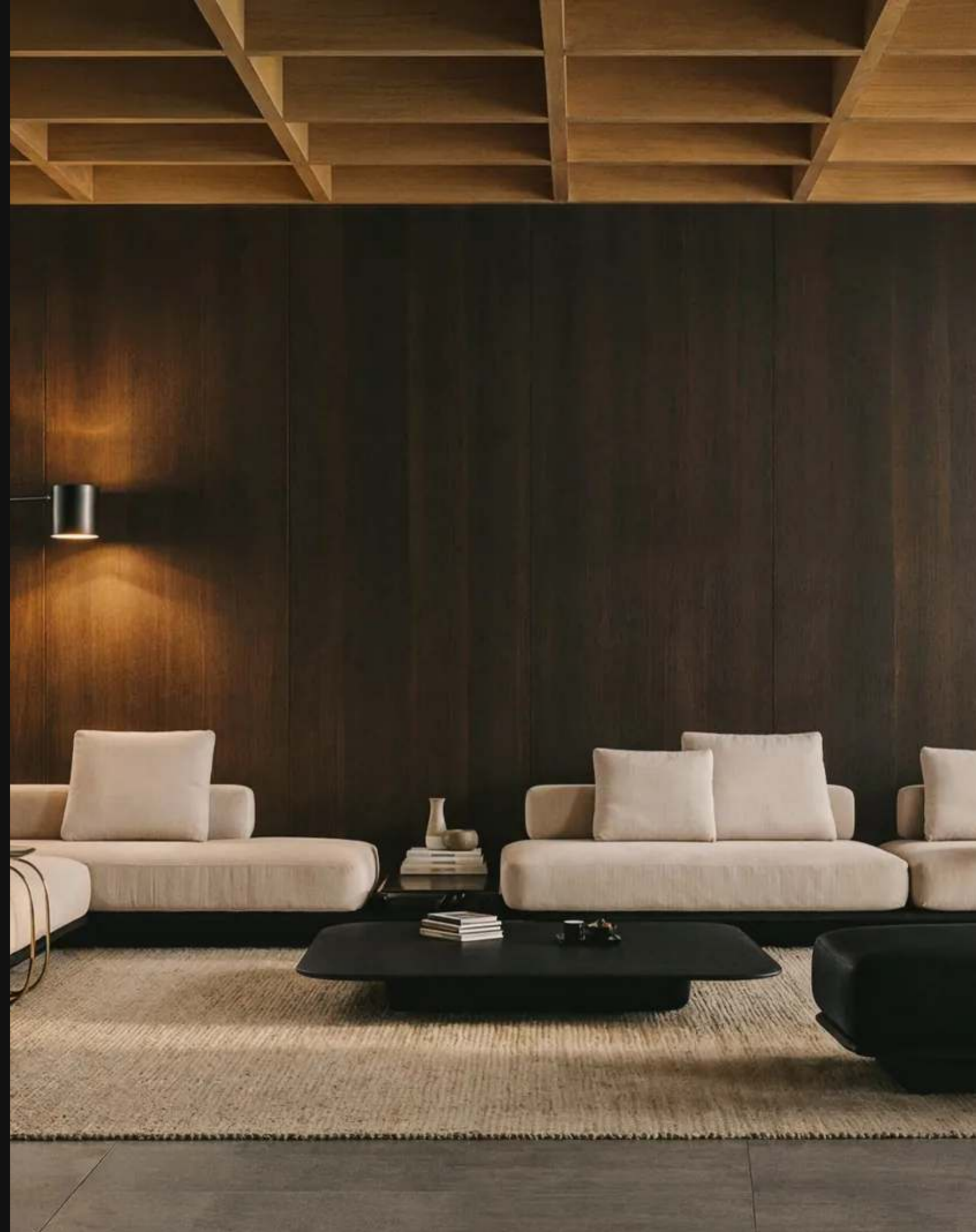



THE FINAL TEST

# The part that's hardest to photograph.

---

People see the piece, then their hand moves before they've decided to move it. Along the table edge. Around the chair back. Across the transition where oak meets fabric. One person said "your hand doesn't want to leave." We call it reverie. We still use it as a test.

EXPERIENCE ENWA

# Eight pieces. Made to order.

Designed in Tokyo. DDP worldwide. [studio@mililab.co](mailto:studio@mililab.co) · [mililab.co](https://mililab.co)

[studio@mililab.co](mailto:studio@mililab.co)

[mililab.co](https://mililab.co)

© 2026 Mililab Co., Ltd.

↓ [DOWNLOAD LOOKBOOK PDF](#)